

Installation instructions: Shelving with Wooden Brackets

Items included

Shelf



Wooden Brackets



Screws



Drywall Anchors



Wire Poker



Putty



Phillips Head Driver



Tools you'll need

Drill



Level

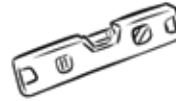

Pencil



Stud Finder



1 Position the First Bracket

Place one of the wooden brackets against the wall.



Tip: We recommend having the bracket's grain pattern run perpendicular to the wall for aesthetics, but it's your choice!

Ideally, place brackets 2-3" in from the shelf edge, but adjust according to your preference.

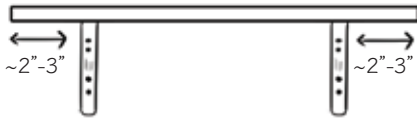

2 Mark Bracket Placement

Using the wire poker, score the wall through the two wall-facing holes on the bracket.

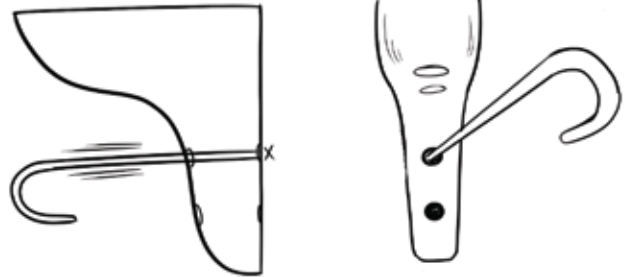

3 Secure the First Bracket

Preferably, attach brackets to wall studs for enhanced stability.

If mounting on drywall:

1. Drill pilot holes using a $9/32$ " drill bit.

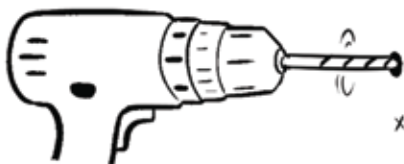

2. Insert the drywall anchors until flush with the wall.



Attach the bracket using the 3" screws. Avoid overtightening.

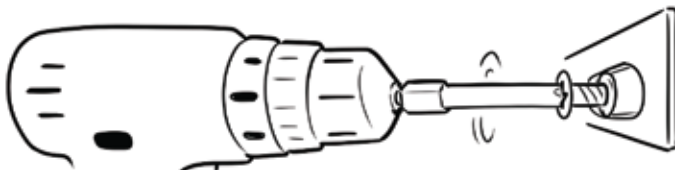

Installation instructions: Shelving with Wooden Brackets

4 Position & Install the Second Bracket

Using a level, align the second bracket to ensure the shelf will sit evenly.

Repeat the process from Step 3 to install the second bracket.

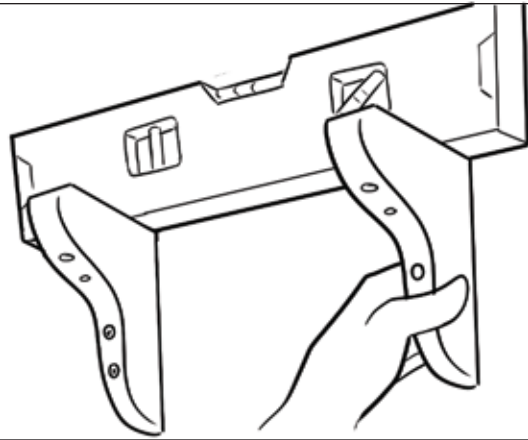

5 Prepare the Shelf

Position the shelf on the brackets.

Score the shelf at the bracket holes using the wire poker.

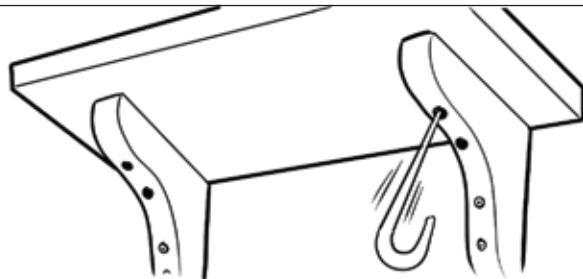

6 Drill Pilot Holes for Shelf

Using a 1/8" drill bit, create pilot holes where you've scored the shelf.

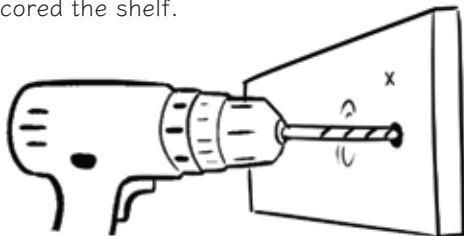

7 Secure the Shelf

Attach the shelf to the brackets using the 2" screws. Avoid overtightening.



8 Completion

Voila! Your Shelf is Ready!

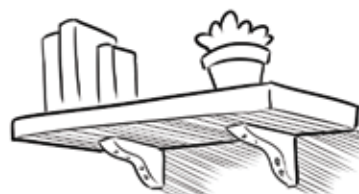

Optional

For a polished look, use the provided wood buttons to cover screw holes on the brackets.

Apply a tiny dab of putty to ensure the buttons remain firmly in place.

Tip: A little putty goes a long way!

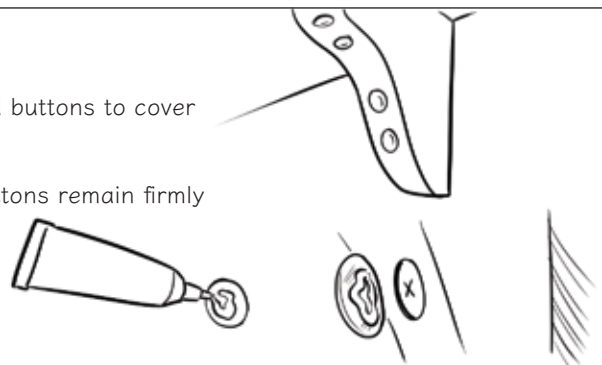

Visit nookwoodworking.com for more tips and tricks!