

# Installation instructions: Coathanger Shelf

## Items included

Coathanger Shelf

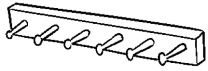

French Cleat Brackets



Screws



Drywall Anchors



## Tools you'll need

Drill



Level

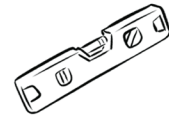

Pencil



## 1 Preparation

Establish the shelf location.

Use a level to draw a horizontal line at the top of the shelf. Also, mark the wall at the center of the french cleats that are already installed on the shelf.

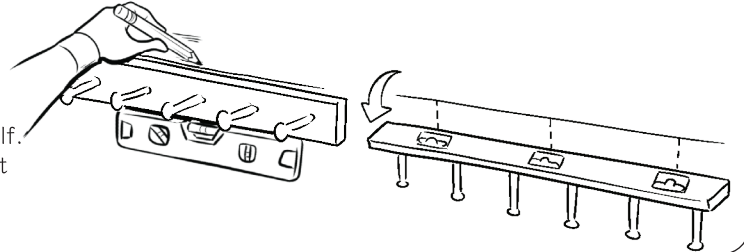

## 2 Align the French Cleats

Position the french cleats on the wall, ensuring the center aligns with the centerline and the top is ~1 1/2" below the horizontal line from Step 2.

Mark the screw hole locations.

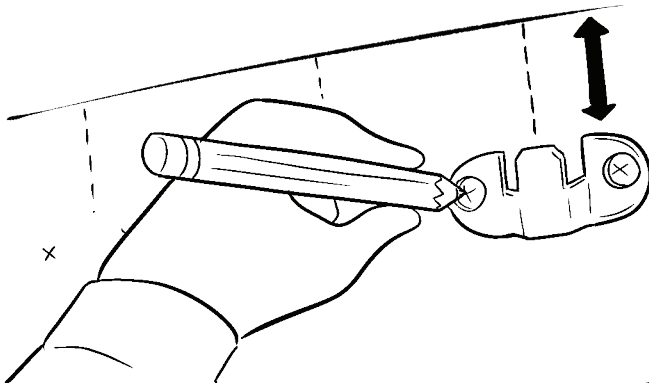

## 3 Drill Pilot Holes

For drywall: Use a 3/16" drill bit. Drill pilot holes where you've made your markings. Gently tap in anchors into these holes. (If the 3/16" drill bit seems too small, carefully opt for a slightly larger size).

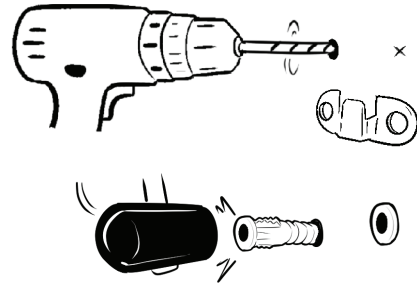

For Wood or Stud: Utilize a 3/32" drill bit for your pilot holes. Anchors are not required.

## 4 Install the French Cleats

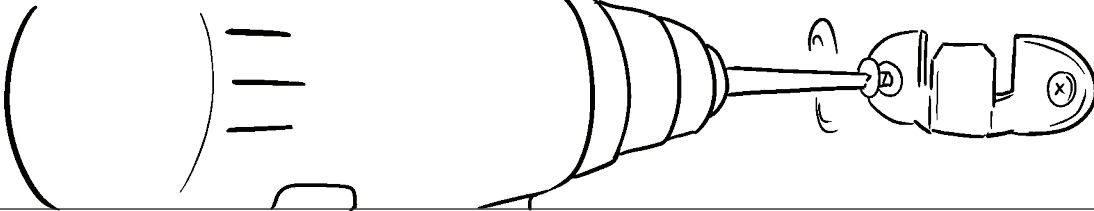

## 5 Mount the Coathanger Shelf

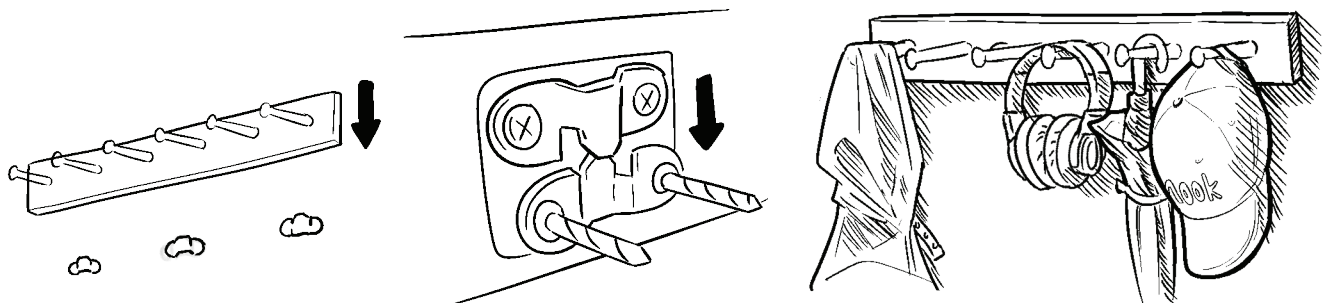

Visit [nookwoodworking.com](http://nookwoodworking.com) for more tips and tricks!