

Installation instructions: 6-8" Deep Floating Shelves

Items included

Shelves



T-Brackets



Screws



Drywall Anchors



Tools you'll need

Drill



Drill Bit



Level

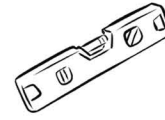

Pencil



The T-brackets may be tight when removing them from the shelf. If so, employ a screwdriver and/or needle nose pliers to assist. Avoid prying against the shelf's outside rim. Instead, target the center to prevent any potential breakage or damage to the shelf edge.

1 Prepare for Marking

Pull the T-brackets halfway out from the shelf. This will reveal the screw hole locations.

Position the shelf against the wall where you'd like it installed and mark the screw hole locations for one bracket.

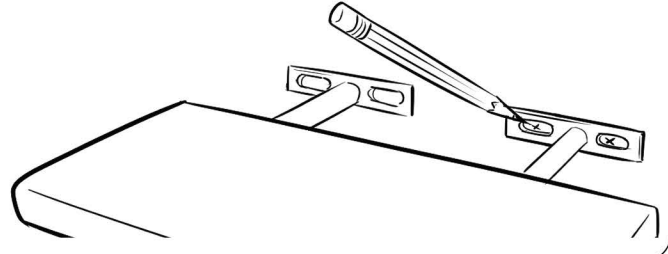

2 Drill Pilot Holes

For drywall: Use a 9/32" drill bit. Drill pilot holes where you've made your markings. Insert the self-driving anchors until they are flush with the wall surface.

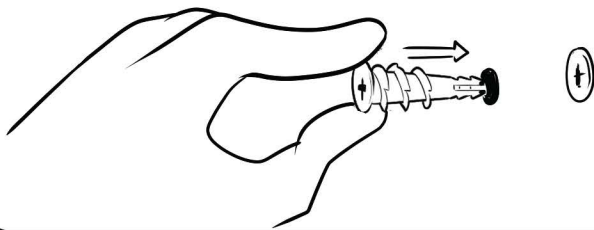
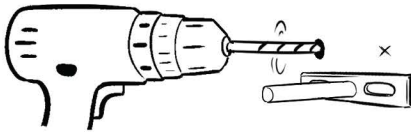

3 Install T-brackets

Attach the first T-bracket.

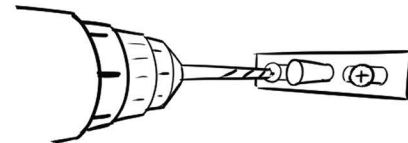

Slide the shelf partially onto this bracket. Align and mark the holes for the remaining T-brackets using a level. Attach the remaining brackets to the wall (repeat step #2)

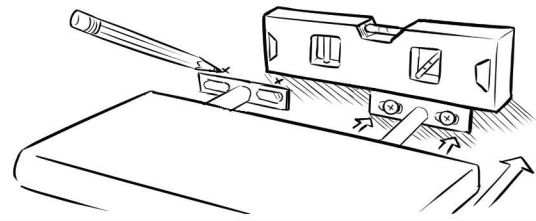

4 Adjustment (if needed)

If the shelf doesn't smoothly fit onto a T-bracket, slightly loosen the relevant screw(s). Adjust the bracket left, right, up, or down as needed, then retighten the screw(s). Ensure the shelf slides snugly onto all T-brackets.

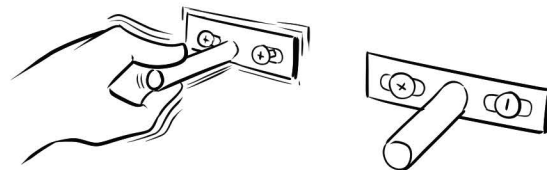

5 Completion

Once the shelf is securely in place and aligned, your installation is complete. Enjoy your new floating shelf!

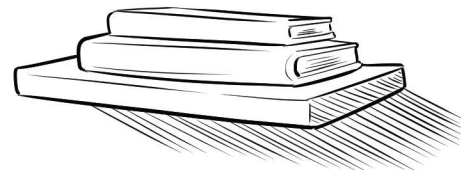

Visit nookwoodworking.com for more tips and tricks!